

PROGRAMS/PROJECTS AND STRATEGIES TO BE IMPLEMENTED BY THE AGENCY CONSISTENT WITH THE 10-POINT ECONOMIC AGENDA UNDER PRESIDENT DUTERTE'S ADMINISTRATION/2019 SONA/PUBLIC EXPENDITURE MANAGEMENT (PEM) AND PUBLIC FINANCIAL MANAGEMENT REFORMS

The priority programs/projects and activities of SPDA shall support the following 10-point Economic Agenda under President Duterte:

- ✚ **Continue and maintain the current macroeconomic policies of the Duterte Administration and pursue a genuine agricultural development strategy by providing support services to small farmers and rural development with the public-private partnership playing a key role**
- ✚ **Promoting rural and value chain development toward increasing agricultural and rural enterprise productivity and rural tourism**
- ✚ **Investing in human capital development through skills training to meet the demands of the business and private sector**
- ✚ **Promoting science and agri-technology in its projects towards self-sustaining and inclusive development**

Some of the programs and projects of the Agency are located in areas belonging to the marginalized or poor areas and target marginalized sectors like the fishermen and farmers. Among such projects are the **SPDA Vitali Fishpond Project** where the local fishermen and the SPDA stewards of the distributed fishponds are partnering in the production of aquaculture particularly milkfish and prawns.



Likewise, SPDA shall fill-in the gaps in the poultry demand and supply in the Zamboanga City and neighboring areas of Zamboanga City like Basilan through the production of broiler in partnership with a poultry integrator.



The development of the 26,000 hectares more or less **Wao and Bumbaran, Lanao del Sur property proclaimed to SPDA** into an agro-industrial complex will eventually lead to the production of crops and goods that can be exported to other countries particularly halal products, hence contributing to economic growth. More businesses establish in the area would mean more employment and taxes generated and development of more infrastructures. Likewise, SPDA shall spearhead the promotion of investments to the 26,000 hectares more or less area in Lanao del Sur. The influx of businesses to the area will bring about development to the area. With economic development and opportunities for jobs provided, food on the table for every family as envisioned will bring about peace and harmony.

Plans are being pursued by SPDA for the production of corn with a private agricultural company that will be utilized for cattle feeds using the private company’s technology of mechanically harvesting the whole corn plant and eventually baled and exported to the Middle East within the areas shall be the initial activity to be undertaken.



Initial target activity/investment locator : Corn silage production for cattle feeds

Address bottlenecks in land administration and management system

On the social aspect, SPDA shall contribute to the *empowerment of the marginalized homeless sector by partnering with the government housing institutions like National Housing Authority and Non-Government Organizations engaged in assisting the landless and homeless sector as mobilizers by giving the informal settlers opportunities to own the land they are currently occupying* through various land acquisition schemes of the National Government like Community Mortgage Program and Community Land Acquisition and Support Program.

SPDA Catitipan, Davao City property- subjected to the Community Land Acquisition Support Program (CLASP) of NHA

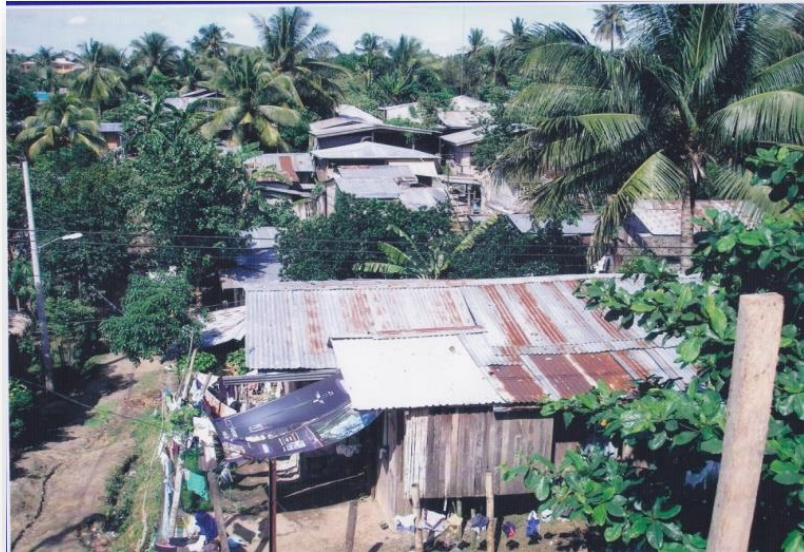

Agreements with the National Housing Authority on the national and Region IX levels were undertaken for the disposition of the SPDA property in Rio Hondo and Mariki, Zamboanga City which was affected by the September 9, 2013 Zamboanga Crisis. The National Housing Authority has initiated construction of settlements/housing for those affected by the conflict and initiated coordination with SPDA as the disposition entity of the subject property consisting of about 5.7 hectares.

It should be recalled that SPDA developed the area as a Muslim Settlement per Presidential Proclamation 1458 and Letter of Instruction No. 481 under the project Sahaya Resettlement/Village where the former MNLF combatants and their families were resettled in the early 1970s. The residential structures of the Rio Hondo and Mariki area consisting of about five (5) hectares has been reduced to nothing.



Other properties subject of socialized housing per Executive Order No. 98 and earlier Slum Improvement & Resettlement mandates and programs of the NHA on socialized housing like the Community Mortgage Program and the Community Land Acquisition and Support Program which are a subjects of negotiation with the informal settlers in the area are the SPDA Valencia City, Don Carlos and Maramag Properties in Bukidnon; SPDA Sasa, Davao City Property occupied by the Sasa Urban Housing Association (SUHA) and the SPDA Malagamot, Davao City property.

SPDA Maramag, Bukidnon Property



SPDA Valencia City, Bukidnon Property



Pursuit of INCLUSIVE Peace (continuity of peace agreements...)

In 1996, after the Final Peace Agreement with the MNLF, SPDA was identified to support the realization of some of the provisions of this Agreement. SPDA was again mandated in 2006 by virtue of Executive Order 560 to implement an Economic Catch-Up Plan for the MNLF. Recently, SPDA was again cited in the signed Comprehensive Agreement on the Bangsamoro (CAB) with the MILF as one of the institutional mechanisms for Bangsamoro's revenue and wealth sharing concerns.

- The inclusion of SPDA in the ANNEX ON REVENUE GENERATION AND WEALTH SHARING FIRST IN THE FRAMEWORK AGREEMENT ON THE BANGSAMORO ON JULY 13, 2013 AND SUBSEQUENTLY IN THE COMPREHENSIVE AGREEMENT ON THE BANGSAMORO (CAB) and on January 2019, the BANGSAMORO ORGANIC LAW (BOL) CREATING THE BANGSAMORO AUTONOMOUS REGION FOR MUSLIM MINDANAO (BARMM) UNDER ARTICLE XII - FISCAL AUTONOMY OF GOVERNMENT OWNED AND/OR CONTROLLED CORPORATIONS (GOCCS) AND FINANCIAL INSTITUTIONS ON SECTION 33 which states that “*Southern Philippine Development Authority and Al-Amanah Islamic Investment Bank. – Within six (6) months from the establishment of the BTA, the Intergovernmental Fiscal Policy Board shall determine the participation of the Bangsamoro in the ownership and management of Al-Amanah Islamic Investment Bank of the Philippines and the Southern Philippines Development Authority as provided in P.D. 690, as amended by P.D. 1703, and the mode of transfer of ownership to the Bangsamoro Government*”, SPDA anticipates to continue to become a mechanism for peace and development.

On the matter, SPDA submitted to Chief Minister Murad its proposed role in the BARMM in a meeting held on June 25, 2019 at the Chief Minister's office in Cotabato City citing among others SPDA's proposal to be “BARMMMS corporate partner in initiating economic and social developmental programs” particularly for Muslim communities within BARMM and be BARMM's extension arm for Muslim communities outside of BARMM with still about 2 million Muslims residing outside of BARMM within Mindanao.

2015 Population of Muslims in the Regions of Mindanao		
Region	Muslims	Percentage from Mindanao's Population
Region 9 Zamboanga Peninsula	603,289	2.50%
Region 10 Northern Mindanao	378,019	1.57%
Region 11 Davao Region	167,879	0.70%
Region 12 SOCCSKSARGEN	1,032,824	4.28%
Region 13 Caraga	12,355	0.05%
Autonomous Region in Muslim Mindanao (ARMM)	3,451,644	14.30%
MINDANAO	5,646,010	23.39%

- Address the MNLF communities outside of BARMM socio-economic and cultural needs through an inclusive and wholistic approach to peace and development. As such, SPDA proposes the establishment of the **PEACE (People Economic Advancement and Community Empowerment) Villages** starting with the Municipality of Tungawan, Zamboanga Sibugay. This shall be replicated in other MNLF communities still wanting of government and private sector interventions and through tie-up with the MILF leaders with the normalization of their various camps.

Initial Proposed Pilot PEACE VILLAGE – Barangays Look Labuan, Tigbukay, Taglibas, Linguisan and Tigbanuang in the Tungawan, Municipality, Zamboanga Sibugay

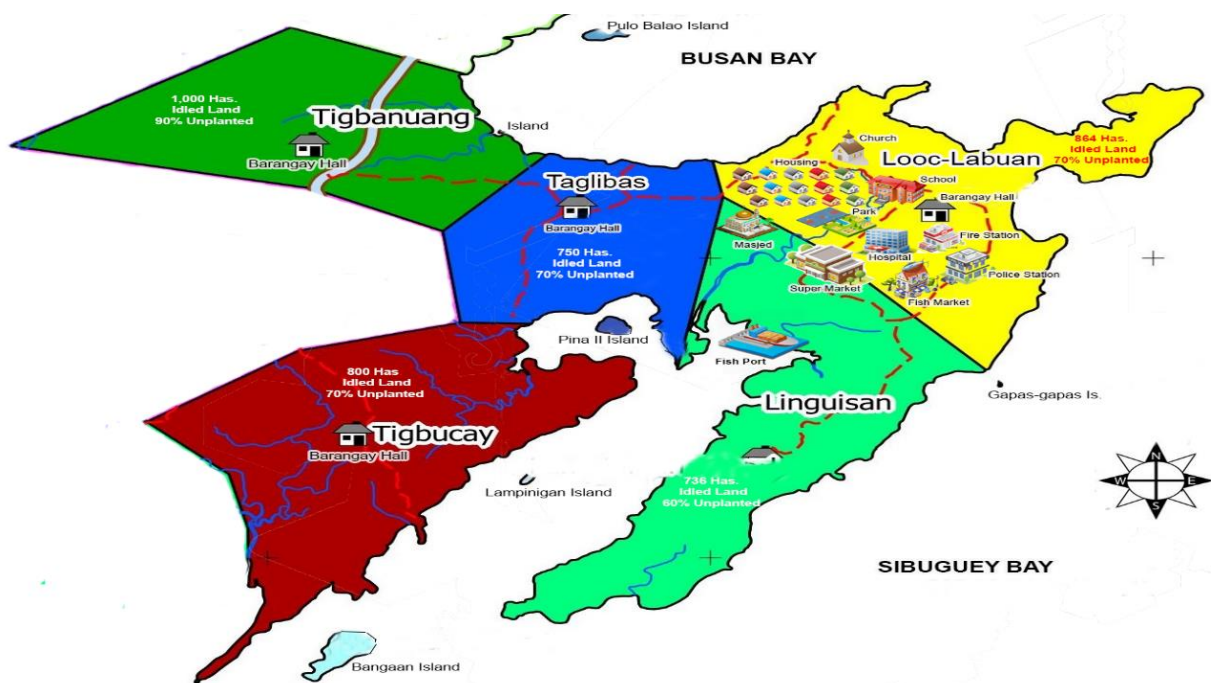

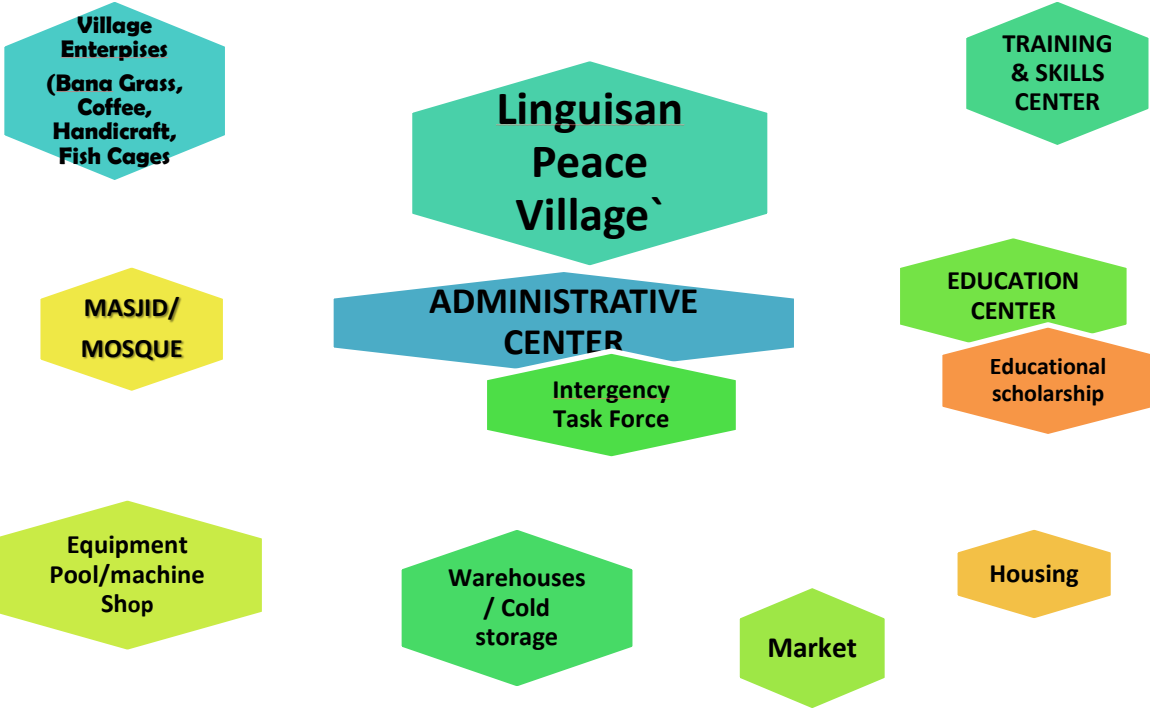

Consultation/Workshops with the Stakeholders of the proposed PEACE Village



Overview of Looc Labuan, Tungawan

Partnership with Private Sector in Economic Development Undertakings (PPP) in support of the agenda on increasing competitiveness and the ease of doing business

Negotiations with private local and foreign companies are being undertaken for joint undertaking/development of some of SPDA's projects suitable for agricultural development of Wao and Amay Manabilang Municipalities in Lanao del Sur, BARMM, housing and mix-use commercial development/township of the SPDA property in Bonbon, Butuan City; Pasobolong, Zamboanga City; Hospitals for the SPDA properties in Talon-Talon, Zamboanga City and Davao City.

Recommended Mixed Use Residential and Commercial Center for the SPDA Bonbon, Butuan City Property



The recommended conceptual perspective for the SPDA Bonbon, Butuan City Property is a “ A One-Stop Residential and Commercial Center” with an initial indicative projected cost of Php5, 113,375,088.54 given that the assumed allocation per square meter is between Php25, 000.00 and Php35, 000. Of this allocation, approximately Php1.422 billion will go to the development of the open space which will include; roads, canals and drainages, electrical supply system, water supply system, wastewater treatment facilities, clubhouses, swimming pools, police station, fire station, gasoline station, pocket parks, outdoor parkings, and health center; and the rest will go to the development of the 4-storey commercial mall in a 5, 000.00 sqm lot, 2 4-storey residential condominium (2,000sqm), 2 3-storey residential condominium (1,600sqm), 2 4-storey commercial building (2000sqm), 2 3-storey commercial building (1,600sqm), 2 2-storey DORMITEL (1,600sqm); 2-storey detached houses economic subdivision in a 30, 000.00 sqm lot; and finally, 3 2-storey school building for elementary and high school (3,586sqm). It is recommended that its development will be progressive type.

SPDA Catalunan Pequeño, Davao City property proposed development into a Medical City



*Development Perspectives of the SPDA Catalunan Pequeño Property into a Medical City
(Hospital, Medical School, Condominium, Commercial Spaces)*



Hospital/Medical Complex



Medical School

SPDA Veterans Avenue, Zamboanga City Property Development into a Mix-Use Commercial and Hotel

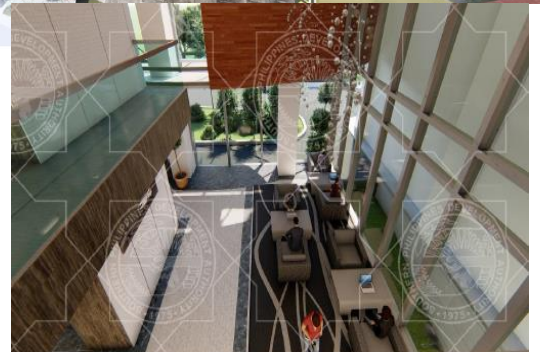



Gold & Star Medical Complex is a 300-bed state-of-the-art level 3 hospital facility that will be located at SPDA's property at Brgy. Talon-talon, Zamboanga City. The Hospital will cater to the general population of Zamboanga City as its primary market while Zamboanga Del Norte, Zamboanga Sibugay and Basilan provinces as its secondary market

- **Pursue coordination and consultation with the Mindanao Development Authority (MinDa) and other agencies and funding institutions for big ticket projects such as the Mindanao Railway System as part of the President's agenda for the social and economic development efforts in Mindanao as a government corporate arm under the PPP concept.**